

**Proposed Project at Mouza-Sadhanpur, J.L. No-69, R.S. Plot No-2076, 2078, 2079, 2080, R.S. Khatian No-516, 517, 518, 521, L.R. Plot No-2831, 2834, 2835, 2836, L.R. Khatian No-8384, 8385, Ward No-07, Mahalla- P.C. Mitra Lane, Holding No-105, under Burdwan Municipality, P.S.-Burdwan Sadar, District-Purba Bardhaman**

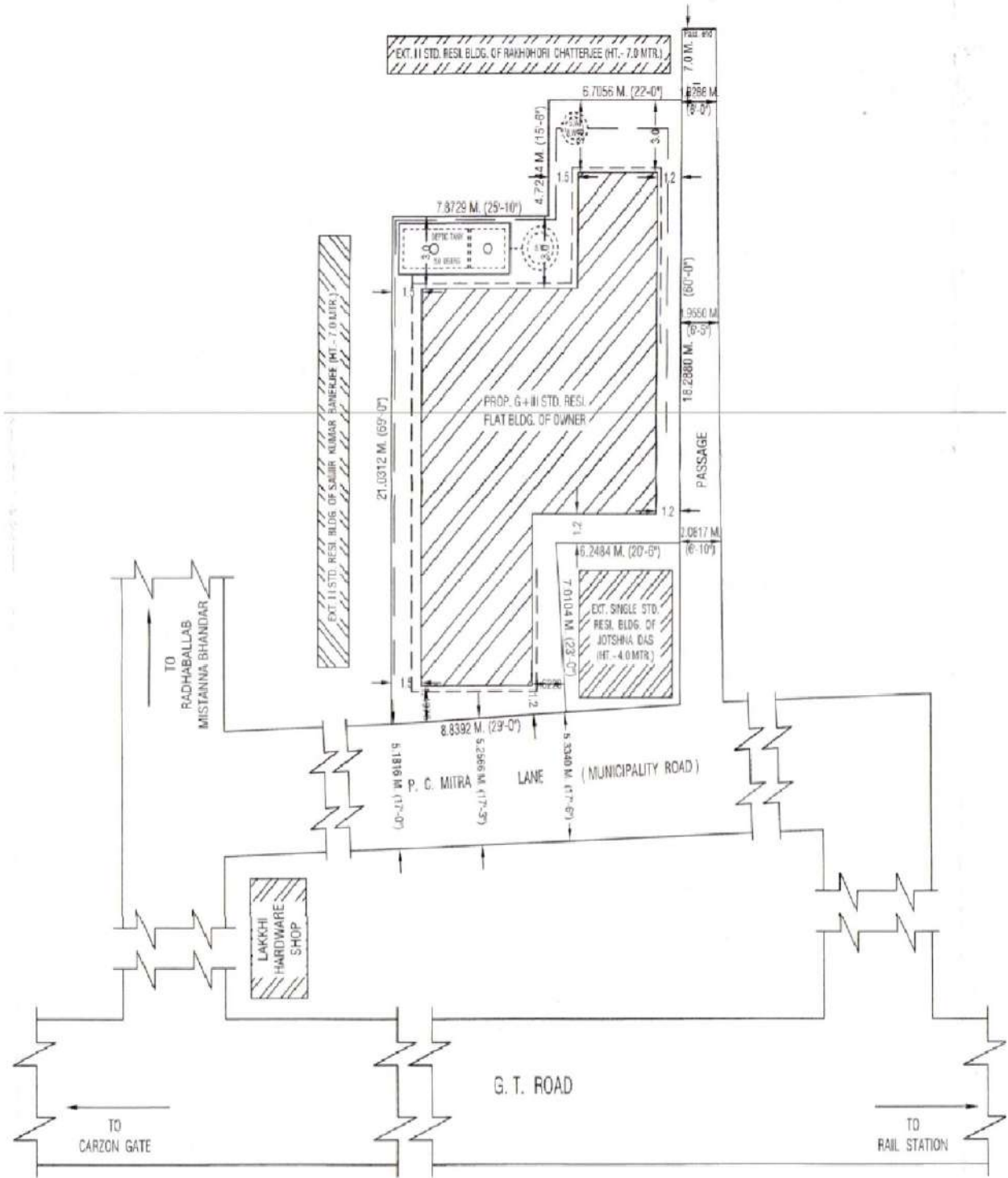

**LATITUDE : 23.245668**  
**LONGITUDE : 87.865488**

**Dream House Construction**

*Nalufar Yasmin*

**Partner**

**SIGNATURE OF OWNER**